

U.S. TSUBAKI POWER-LOCK®

MOST POPULAR STYLE

AS Inch Series Stainless Steel

Hub Diameters for Single Unit Installation

D_N is the minimum hub diameter required to tolerate P' or the pressure exerted from within the hub.

$$B \geq 2\ell$$

<EXAMPLE> Hub Material Yield Point = 35500 psi
PL2AS-SS = 4.437" min. hub diameter

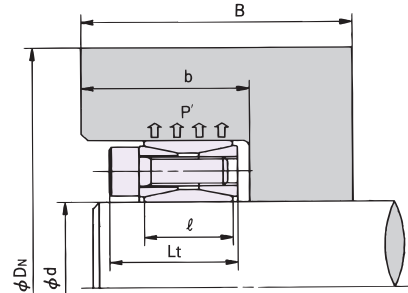

Hub Configuration Coefficient $K_3=0.6$

Min. Hub Dia. (D_N in inches)

Model Number	Hub Contact Pressure P' (psi)	Yield Point and Material examples									
		147 Mpa 21300 psi	176 Mpa 25500 psi	206 Mpa 29900 psi	225 Mpa 32600 psi	245 Mpa 35500 psi	274 Mpa 39700 psi	294 Mpa 42600 psi	343 Mpa 49700 psi	392 Mpa 56900 psi	441 Mpa 64000 psi
				1010 304SS 316SS	1015 1118	1020	1030	1035 1040 1144	4140 1045	1055	
PL3/4 AS-SS	10,443	2.504	2.377	2.289	2.247	2.211	2.169	2.145	2.010	2.066	2.041
PL7/8 AS-SS	10,443	2.504	2.377	2.289	2.247	2.211	2.169	2.145	2.010	2.066	2.041
PL1 AS-SS	12,909	2.881	2.693	2.567	2.508	2.457	2.399	2.366	2.304	2.258	2.224
PL1-1/8 AS-SS	11,748	3.052	2.875	2.753	2.696	2.647	2.590	2.558	2.497	2.452	2.418
PL1-3/16 AS-SS	11,748	3.044	2.867	2.746	2.689	2.640	2.583	2.551	2.490	2.446	2.412
PL1-1/4 AS-SS	13,489	3.522	3.280	3.118	3.043	2.978	2.904	2.862	2.783	2.726	2.682
PL1-3/8 AS-SS	13,489	3.527	3.284	3.122	3.047	2.982	2.908	2.866	2.787	2.729	2.686
PL1-7/16 AS-SS	13,779	3.853	3.581	3.400	3.315	3.243	3.160	3.114	3.026	2.963	2.914
PL1-1/2 AS-SS	13,779	3.853	3.581	3.400	3.315	3.243	3.160	3.114	3.026	2.963	2.914
PL1-5/8 AS-SS	15,229	4.669	4.295	4.050	3.937	3.842	3.732	3.671	3.556	3.473	3.410
PL1-11/16 AS-SS	15,229	4.669	4.295	4.050	3.937	3.842	3.732	3.671	3.556	3.473	3.410
PL1-3/4 AS-SS	15,229	4.669	4.295	4.050	3.937	3.842	3.732	3.671	3.556	3.473	3.410
PL1-7/8 AS-SS	14,214	4.812	4.459	4.225	4.116	4.024	3.917	3.858	3.745	3.664	3.602
PL1-15/16 AS-SS	14,214	4.812	4.459	4.225	4.116	4.024	3.917	3.858	3.745	3.664	3.602
PL2 AS-SS	16,390	5.510	5.023	4.710	4.567	4.446	4.308	4.232	4.088	3.985	3.907
PL2-1/8 AS-SS	16,390	5.510	5.023	4.710	4.567	4.446	4.308	4.232	4.088	3.985	3.907
PL2-3/16 AS-SS	15,519	5.659	5.193	4.891	4.751	4.633	4.498	4.423	4.282	4.180	4.102
PL2-1/4 AS-SS	15,519	5.659	5.193	4.891	4.751	4.633	4.498	4.423	4.282	4.180	4.102
PL2-3/8 AS-SS	15,519	5.639	5.176	4.874	4.735	4.618	4.483	4.408	4.267	4.166	4.089
PL2-7/16 AS-SS	15,954	6.065	5.547	5.213	5.060	4.930	4.782	4.700	4.545	4.433	4.349
PL2-1/2 AS-SS	15,954	6.065	5.547	5.213	5.060	4.930	4.782	4.700	4.545	4.433	4.349
PL2-9/16 AS-SS	15,954	6.060	5.543	5.209	5.056	4.926	4.778	4.696	4.541	4.429	4.345
PL2-5/8 AS-SS	17,260	7.371	6.670	6.226	6.025	5.855	5.663	5.557	5.357	5.214	5.107
PL2-11/16 AS-SS	17,260	7.371	6.670	6.226	6.025	5.855	5.663	5.557	5.357	5.214	5.107
PL2-3/4 AS-SS	17,260	7.371	6.670	6.226	6.025	5.855	5.663	5.557	5.357	5.214	5.107
PL2-7/8 AS-SS	16,390	7.457	6.797	6.373	6.180	6.016	5.830	5.727	5.532	5.392	5.287
PL2-15/16 AS-SS	16,390	7.457	6.797	6.373	6.180	6.016	5.830	5.727	5.532	5.392	5.287
PL3 AS-SS	15,809	7.622	6.979	6.563	6.372	6.210	6.026	5.923	5.730	5.590	5.485
PL3-3/8 AS-SS	16,535	8.146	7.416	6.949	6.736	6.556	6.351	6.237	6.023	5.870	5.754
PL3-7/16 AS-SS	15,809	8.257	7.561	7.111	6.904	6.728	6.528	6.417	6.208	6.057	5.943
PL3-1/2 AS-SS	15,809	8.257	7.561	7.111	6.904	6.728	6.528	6.417	6.208	6.057	5.943
PL3-3/4 AS-SS	16,535	8.782	7.995	7.491	7.261	7.067	6.846	6.724	6.493	6.328	6.203
PL3-15/16 AS-SS	16,390	9.400	8.568	8.034	7.790	7.584	7.349	7.219	6.974	6.798	6.665
PL4 AS-SS	15,954	9.475	8.667	8.144	7.905	7.702	7.470	7.342	7.100	6.926	6.794