

MOST POPULAR STYLE

# AS Inch Series

## Hub Diameters for Single Unit Installation

$D_N$  is the minimum hub diameter required to tolerate  $P'$  or the pressure exerted from within the hub.

$$B \geq 2\ell$$

<EXAMPLE> Hub Material Yield Point = 35500 psi  
 PL2AS = 4.658" min. hub diameter

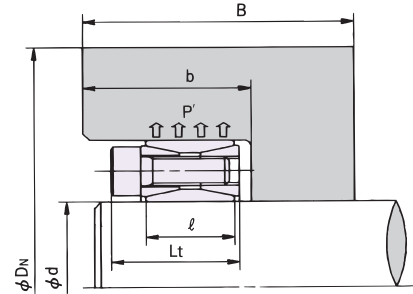

Hub Configuration Coefficient  $K_3=0.6$

### Min. Hub Dia. ( $D_N$ in inches)

Model Number	AS	Hub Contact Pressure $P'$ (psi)	Yield Point and Material examples									
			147 Mpa	176 Mpa	206 Mpa	225 Mpa	245 Mpa	274 Mpa	294 Mpa	343 Mpa	392 Mpa	441 Mpa
			21300 psi	25500 psi	29900 psi	32600 psi	35500 psi	39700 psi	42600 psi	49700 psi	56900 psi	64000 psi
PL3/4	AS	12370	2.660	2.496	2.384	2.332	2.287	2.235	2.206	2.150	2.110	2.079
PL7/8	AS	12370	2.660	2.496	2.384	2.332	2.287	2.235	2.206	2.150	2.110	2.079
PL1	AS	14650	3.052	2.819	2.666	2.595	2.535	2.466	2.427	2.354	2.301	2.261
PL1-1/8	AS	13370	3.216	2.997	2.851	2.783	2.724	2.657	2.619	2.547	2.495	2.456
PL1-3/16	AS	13370	3.207	2.989	2.843	2.775	2.717	2.649	2.612	2.540	2.489	2.449
PL1-1/4	AS	15360	3.752	3.447	3.249	3.158	3.080	2.991	2.942	2.849	2.782	2.731
PL1-3/8	AS	15360	3.756	3.452	3.253	3.162	3.084	2.995	2.946	2.852	2.785	2.734
PL1-7/16	AS	15500	4.084	3.749	3.531	3.431	3.345	3.248	3.194	3.092	3.018	2.963
PL1-1/2	AS	15500	4.084	3.749	3.531	3.431	3.345	3.248	3.194	3.092	3.018	2.963
PL1-5/8	AS	17490	5.062	4.571	4.262	4.121	4.004	3.870	3.796	3.658	3.559	3.485
PL1-11/16	AS	17490	5.062	4.571	4.262	4.121	4.004	3.870	3.796	3.658	3.559	3.485
PL1-3/4	AS	17490	5.062	4.571	4.262	4.121	4.004	3.870	3.796	3.658	3.559	3.485
PL1-7/8	AS	16350	5.180	4.723	4.430	4.296	4.182	4.053	3.981	3.847	3.750	3.677
PL1-15/16	AS	16350	5.180	4.723	4.430	4.296	4.182	4.053	3.981	3.847	3.750	3.677
PL2	AS	18910	6.055	5.395	4.990	4.809	4.658	4.488	4.395	4.220	4.096	4.003
PL2-1/8	AS	18910	6.055	5.395	4.990	4.809	4.658	4.488	4.395	4.220	4.096	4.003
PL2-3/16	AS	17780	6.140	5.530	5.147	4.975	4.829	4.665	4.575	4.405	4.284	4.193
PL2-1/4	AS	17780	6.140	5.530	5.147	4.975	4.829	4.665	4.575	4.405	4.284	4.193
PL2-3/8	AS	17780	6.119	5.511	5.130	4.958	4.813	4.650	4.559	4.390	4.269	4.178
PL2-7/16	AS	18340	6.620	5.932	5.504	5.312	5.151	4.970	4.870	4.683	4.550	4.450
PL2-1/2	AS	18340	6.620	5.932	5.504	5.312	5.151	4.970	4.870	4.683	4.550	4.450
PL2-9/16	AS	18340	6.615	5.927	5.500	5.308	5.147	4.966	4.866	4.680	4.546	4.446
PL2-5/8	AS	19340	7.983	7.083	6.534	6.290	6.087	5.859	5.734	5.500	5.334	5.210
PL2-11/16	AS	19340	7.983	7.083	6.534	6.290	6.087	5.859	5.734	5.500	5.334	5.210
PL2-3/4	AS	19340	7.983	7.083	6.534	6.290	6.087	5.859	5.734	5.500	5.334	5.210
PL2-7/8	AS	18490	8.061	7.213	6.687	6.452	6.254	6.032	5.910	5.681	5.518	5.395
PL2-15/16	AS	18490	8.061	7.213	6.687	6.452	6.254	6.032	5.910	5.681	5.518	5.395
PL3	AS	17780	8.186	7.373	6.863	6.633	6.439	6.220	6.010	5.874	5.712	5.590
PL3-3/8	AS	18630	8.809	7.871	7.292	7.032	6.815	6.570	6.436	6.185	6.006	5.871
PL3-7/16	AS	17920	8.916	8.020	7.460	7.207	6.994	6.755	6.622	6.375	6.198	6.065
PL3-1/2	AS	17920	8.916	8.020	7.460	7.207	6.994	6.755	6.622	6.375	6.198	6.065
PL3-3/4	AS	18770	9.548	8.519	7.886	7.603	7.366	7.099	6.953	6.679	6.484	6.338
PL3-15/16	AS	18490	10.162	9.092	8.430	8.133	7.884	7.604	7.450	7.161	6.955	6.801
PL4	AS	18060	10.233	9.193	8.544	8.251	8.006	7.729	7.577	7.291	7.086	6.933
PL4-7/16	AS	17780	11.257	10.139	9.437	9.121	8.855	8.554	8.388	8.077	7.854	7.687
PL4-1/2	AS	17780	11.257	10.139	9.437	9.121	8.855	8.554	8.388	8.077	7.854	7.687
PL4-15/16	AS	17350	12.086	10.927	10.195	9.863	9.584	9.267	9.092	8.764	8.529	8.352
PL5	AS	17350	12.086	10.927	10.195	9.863	9.584	9.267	9.092	8.764	8.529	8.352
PL5-1/2	AS	17490	12.843	11.597	10.812	10.457	10.158	9.819	9.632	9.281	9.030	8.841
PL6	AS	18770	14.881	13.278	12.291	11.849	11.480	11.065	10.836	10.410	10.106	9.878
PL6-1/2	AS	17210	15.028	13.604	12.702	12.292	11.948	11.557	11.341	10.935	10.644	10.425
PL7	AS	17490	15.860	14.322	13.352	12.913	12.544	12.125	11.895	11.462	11.151	10.918
PL7-1/2	AS	16210	16.074	14.672	13.771	13.358	13.008	12.611	12.390	11.974	11.675	11.450
PL7-7/8	AS	16350	16.832	15.347	14.393	13.957	13.589	13.169	12.937	12.499	12.184	11.946
PL8	AS	15930	17.019	15.570	14.633	14.203	13.839	13.424	13.194	12.760	12.447	12.211
PL8-1/2	AS	16640	18.645	16.959	15.882	15.391	14.976	14.504	14.243	13.751	13.398	13.132
PL9	AS	15930	18.906	17.296	16.256	15.779	15.374	14.913	14.658	14.175	13.827	13.565
PL9-1/2	AS	17210	20.620	18.666	17.428	16.866	16.393	15.857	15.560	15.003	14.604	14.304
PL10	AS	18770	23.028	20.548	19.021	18.337	17.766	17.123	16.770	16.110	15.639	15.287
PL10-1/2	AS	18060	23.325	20.954	19.475	18.809	18.250	17.618	17.271	16.619	16.154	15.804
PL11	AS	16500	23.147	21.079	19.755	19.150	18.638	18.057	17.735	17.129	16.693	16.364
PL11-13/16	AS	17060	24.907	22.576	21.096	20.423	19.856	19.212	18.857	18.189	17.709	17.348